



New & Improved Precision Model 9000 Pressure Transducer

- $\pm 0.05\%$ Total Error Band from -40°C to $+85^{\circ}\text{C}$
- Optional Push Button re-zero function
- Transducer is customized to your specific temperature and pressure conditions
- Outputs: 4-20mA, 0-5 Vdc, 0-10 Vdc. Optional 4-wire, isolated outputs and RS232/RS485 available.
- Pressure ranges 0-10" WC to 30,000 PSI
- Built-in, proprietary design, lightning and surge protection supplied as standard
- Unparalleled long-term stability

CE



Spectre's Series 9000 is the first available pressure transducer that is designed, manufactured and calibrated to each application's specific operating conditions. ***Each transducer's output is digitally mapped to correct for any non-linearity or inaccuracies in the sensing element.*** This digital correction provides the most accurate and flexible pressure transducer in the industry.

Performance @ 25°C

$\pm 0.05\%$ Total Error Band
Stability (2 year): $< \pm 0.05\%$ Total Error Band
Over pressure protection: 2X Rated Pressure
Burst Pressure: 5X minimum
Pressure Cycles: >50 Million
Temperature range: -40 to $+85^{\circ}\text{C}$
Optional to $+100^{\circ}\text{C}$

Environmental Data

Storage temp: -50 to $+125^{\circ}\text{C}$
Compensated range: -40 to $+85^{\circ}\text{C}$
Optional: -55 to $+100^{\circ}\text{C}$

Electrical Data

Excitation:

6.0-36 Vdc - 4-20mA output
9-36 Vdc - 0-5 Vdc output
14-36Vdc - 0-10 Vdc output
Option C29: Max 29 Vdc excitation

Optional serial comms: RS232 or RS485
Current consumption: $< 15\text{mA}$
Output load: $> 10\text{K Ohm}$

Physical data

Sensor wetted material: 17-4 PH SS – 316SS,
(others on application)
Body material: 304 or 316SS
Pressure connection: $\frac{1}{4}$ " Male NPT, SAE-4 male
(others on application)

Electrical Connection: 36' wiring leads, DIN, Bendix
Cannon (others on application)





Ordering guide – Example: 9000-A-(0-150PSIG)-2-D-05-EC2

| A | (0-150PSIG) | 2 | D | 05 | EC2 |
|--|--|--|---|-------------------------|---|
| Pressure Port | Range | Units | Output | Accuracy | Connector*** |
| A=1/4" MNPT B=SAE-4 C=Other D=1/8" MNPT E=Autoclave F-250-C | Specify pressure range in: PSI, BAR, kPa or inches WC. | 1=Absolute 2=Gauge 3=Vacuum 4=Sealed 5=Compound 6=Other | D=4-20mA E=0-5VDC F=0-10VDC G=RS232** H=RS485** X=Other (4-wire, isolated versions available- contact factory | ±0.05% Total Error Band | EC1=36" pigtail EC2=DIN 43650 with mate – Large EC3=Mini DIN with mate EC4=Bendix 6-pin EC8=J-box with terminal strip EC9=1/2" NPT with 36" leads ECX=Other |

*BFSL = Best Fit Straight Line

**Combination 4-20mA + Comms available – consult factory

*** Some outputs may preclude use of certain connectors – consult factory for details

Note: Operating temperature must be specified at time of order placement.

Dimensions:

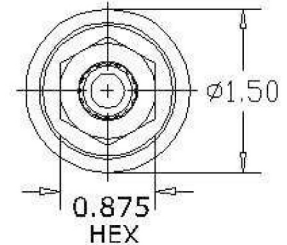
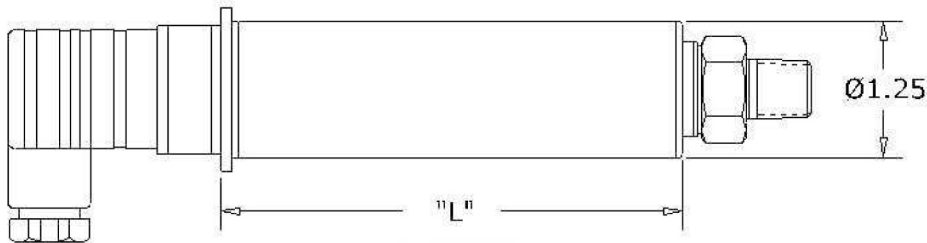

"L" = 4.3" in ranges >300 psi, 5.2" in ranges <300 psi.
Dimensions may vary with options

